

PREPARED BY
HIGHWAY PLANNING SURVEY
IN COOPERATION WITH
U.S. PUBLIC ROADS ADMINISTRATION

STATE OF MINNESOTA
DEPARTMENT OF HIGHWAYS
ROAD LIFE STUDIES
CONSTRUCTION PROJECT LOG RECORD

CONTROL SECTION B207
TRUNK HIGHWAY 61
COUNTY Washington
DISTRICT 9A

LIMITS: Jct. T.H. 8 - N. Co. Line.

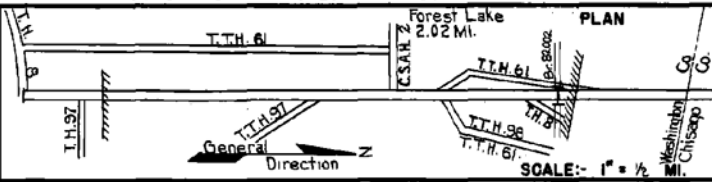

YEAR BUILT	PROJECT NO	DESCRIPTION			CODE NO
		TYPE	WIDTH	THICK-NESS	
		Gravel	22'	2"	No Record of Constr.
1925	61-1-34A	Grading	32'		0.31 Mi. not in use until 1926.
1926	61-1-38B	Grading Concrete	32' 18'	8-7-8	
1926	61-1-34A	Concrete	18'	8-7-8	Widened to 40' and 56' for 0.45 Mile. in Forest Lake.
1937	61-1-38-C	Grading Remove Concrete			Old Roadway - Divided Highway.
1937	61-1-38-C	Grading Shoulders & Ditch			Old Roadway - Divided Highway. 11 Rt. & Lt. of pave.
1937	61-1-38-C	Grading	40'		New Roadway - Divided Highway.
1938	A.F.E. 23	Mixed Bit.	24'	1"	Old Roadway - Divided Highway. Maint. Dept.
1938	A.F.E. 23	Mixed Bit.	24'	1"	New Roadway - Divided Highway. Maint. Dept.
1939	A.F.E. 20	Mixed Bit.	20'	3"	New Roadway - Divided Highway. Maint. Dept.
1939	A.F.E. 34	Shoulder Gray	12'	1"	Old Roadway - Divided Highway. 6 Rt. & Lt. Maint. Dept.
C	8207-06	Concrete	20'	9-7-9	Old Roadway - Divided Highway.
C	8207-06	Grading Concrete Shoulders	38' 22' 16'	9-7-9	New Roadway - Divided Highway. 2x6 Bit. & 1/2 Grav. R&L
C	1940 A.F.E. 50 1941 A.F.E. 50 8207-07	Seeding			New Roadway - Divided Highway.

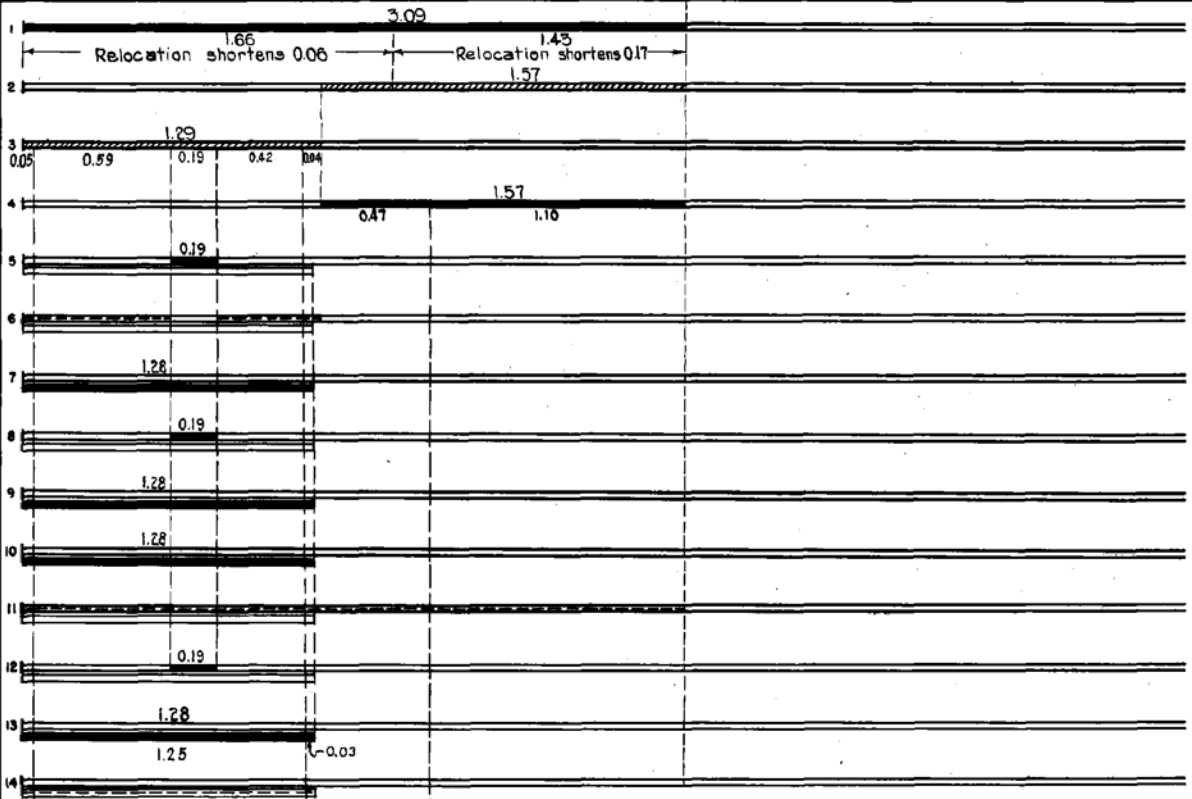

YEARS FROM	TO	TOTAL MILES	UNINCORPORATED		INCORPORATED		RURAL		URBAN	
			RDWY. MI.	BR. MI.	RDWY. MI.	BR. MI.	RDWY. MI.	BR. MI.	RDWY. MI.	BR. MI.
1921	1924	3.09	1.42	0.00	1.67	0.00	3.09	0.00	0.00	0.00
1925	1925	2.92	1.33	0.00	1.59	0.00	2.92	0.00	0.00	0.00
1926	1929	2.86	1.08	0.00	1.78	0.00	2.86	0.00	0.00	0.00
1940	1946	2.86	1.08	0.00	1.78	0.00	1.08	0.00	1.78	0.00
1949	1961	2.85	1.08	0.00	1.77	0.00	1.08	0.00	1.77	0.00
1962		2.85	0.83	0.00	2.02	0.00	0.83	0.00	2.02	0.00

REMARKS: Layout is to scale as of 1926.

PREPARED BY
HIGHWAY PLANNING SURVEY
IN COOPERATION WITH
U.S. PUBLIC ROADS ADMINISTRATION

STATE OF MINNESOTA
DEPARTMENT OF HIGHWAYS
ROAD LIFE STUDIES
CONSTRUCTION PROJECT LOG RECORD

CONTROL SECTION 8207
TRUNK HIGHWAY 61
COUNTY Washington
DISTRICT 9A

LIMITS: Jct. T.H. 8 - N.Co. Line

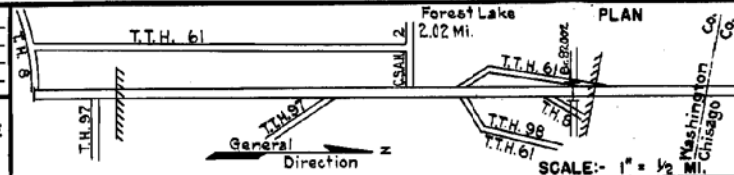

YEAR BUILT	PROJECT N°	DESCRIPTION			CODE N°
		TYPE	WIDTH	THICKNESS	
M	1949 A.F.E. 44	Shoulder Repair			1498 Tons Stab. Grav.
C	1949 8207-08 (1)	Grading P.C. Concrete	48'	9'-7"	0.38 Mi. Divided Highway
C	1949 8207-08 (1)	Grading Bit. Stab. Base Plant Mix Bit.	70'	9" 48' 1 1/2"	Divided Highway
C	1949 8207-15 (1)	Grade Widening Bit. Stab. Base Plant Mix Bit.	30'	11" 24' 5"	Ext. M86D A.F.E. 28 (2)
M	1970 A.F.E. 5	Light Bit. Seal			RCS-1, 1978 Gal. Agg. 72 C.Y.
C	1952 8207-21	Traffic Signals			
M	1952 A.F.E. 5	Light Bit. Seal			RCS-2, 1846 Gal. Agg. 54 C.Y.
M	1953 A.F.E. 831 A.F.E. 628	Drainage Corr. Spot Bit. Lifts & Bit. Seal Coat			In Forest Lake @ 10 th Ave RT-6&AC1, 955 Gal. Agg. 242 Tons
M	1954 A.F.E. 605	Light Bit. Seal			RC-2, 1456 Gal. Agg. 60 C.Y.
C	1954 8207-16	Concr. Base (0.28 Mi.) Asphaltic Concr.	24' 3"	7" 3"	0.05 Mi. Divided Highway On old or new concr.
M	1955 A.F.E. 619	Profile Correction with Plant Mix			Plant Mix 752 Tons S.B. Rdwy. 0.25 Mi. N.B. Rdwy. 0.25 Mi.
M	1957 A.F.E. 819	Profile Corr. with Plant Mix Grav. Shoulders			Plant Mix 1577 Tons Grav. 324 C.Y.
M	1958 A.F.E. 605	Bit. Seal Coat	Var.		RC-5, 3257 Gal. Agg. 122 C.Y.
C	1963 8207-24	Sub-base & Base Asphaltic Concr.	24'	3"	Rt. of concr. surf. imp. On S.B. rdwy.

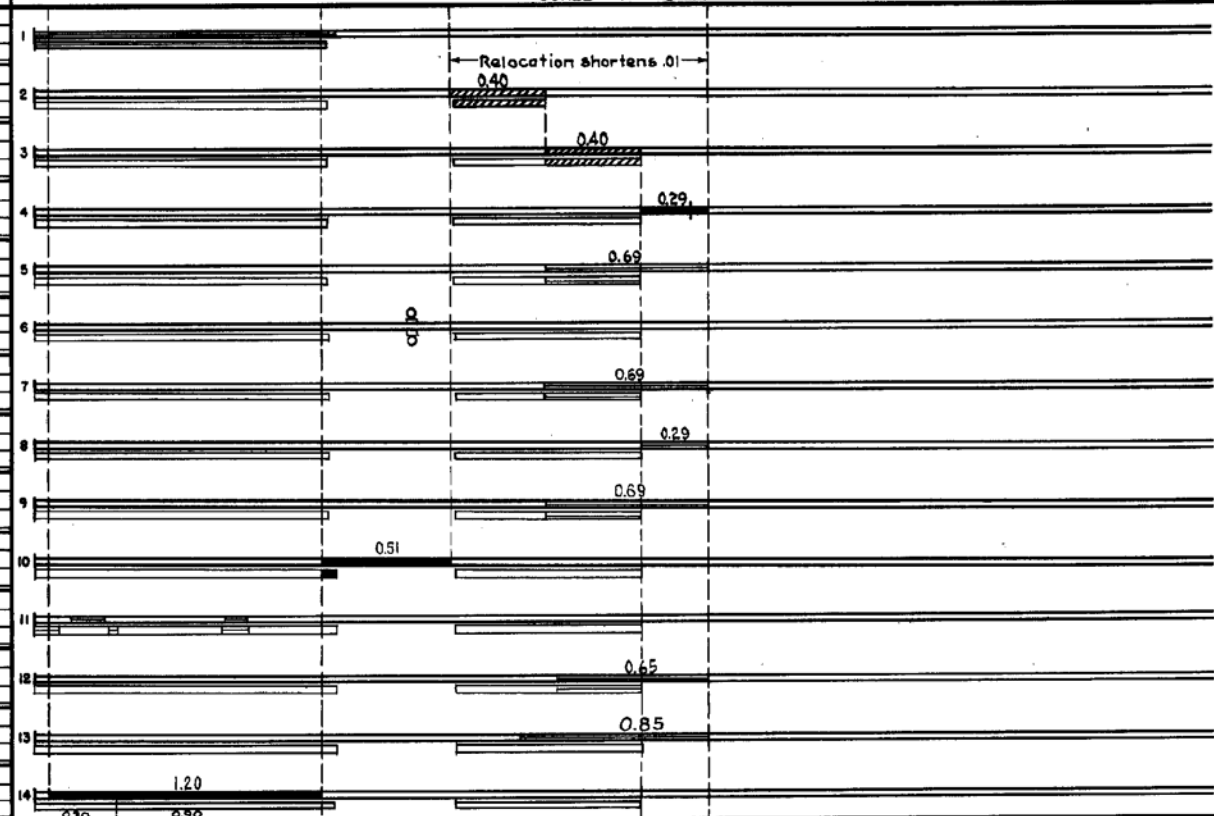

YEARS FROM	TOTAL TO	UNINCORPORATED		INCORPORATED		RURAL		URBAN	
		RDWY. MI.	BR. MI.	RDWY. MI.	BR. MI.	RDWY. MI.	BR. MI.	RDWY. MI.	BR. MI.

REMARKS: See Sheet No. 1
(1) Contract not final on S.P. 8207-06 & 8207-17 but work substantially complete in 1949. (2) A.F.E. 28 covers a temporary 1" x 28" Bit. Mat placed on Bit. Stab. Base.

PREPARED BY
TRAFFIC AND PLANNING DIVISION
IN COOPERATION WITH
U.S. DEPARTMENT OF COMMERCE
BUREAU OF PUBLIC ROADS

STATE OF MINNESOTA
DEPARTMENT OF HIGHWAYS
ROAD LIFE STUDIES
CONSTRUCTION PROJECT LOG RECORD

CONTROL SECTION **8207**
TRUNK HIGHWAY **61**
COUNTY **Washington**
DISTRICT **Metra**

LIMITS: _____

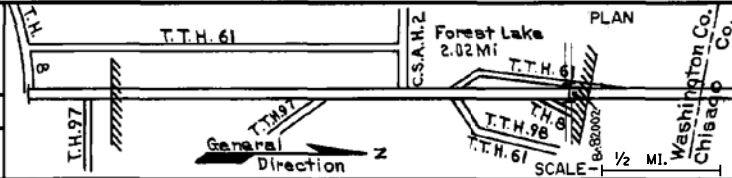

YEAR BUILT	PROJECT NO	DESCRIPTION				REMARKS
		TYPE	WIDTH	THICKNESS		
C	1965	Maint Project 8207-25	Plant Mix Bit Traffic Signals	24'	2 1/2"	
C	1968	8207-27	Asphaltic Concrete Pl. Mix. Bit. Shldrs.	24-24'	2 1/2"	Bit. Mat'l. 15 Ton
C	1968	8207-28	Turning Lanes Asphaltic Concrete Pl. Mix. Bit. Shldrs.	24-24'	2 1/2"	Bit. Mat'l. 57 Ton
C	1969	8207-32	Bit. Resurf.	24'	2 1/4"	N.E. Rdwy for 0.40 Mi.
C	1974	-34	TRAFFIC SIGNAL REVISION			AT BROADWAY IN FOREST LAKE
C	1979	8207-37 FOOL-2 (4%)	TURN LANE	13'		AT RAMP TO T.H. 98
C	1973	8207-35 SF	TURN LANE	13'		AT 6 TH AV X-ING
C	1985	8207-43 FOOL-2 (6%)	Traffic Signals			Broadway, CSAH-2
C	1985	8207-44 FOOL-2 (6%)	Traffic Signals			At 11th Ave.
C	1985	8207-45 FOOL-2 (6%)	Intersection Rev. Bit. Base Bit. Surfacing	34-48' 34-48'	2 1/2" 2 1/2"	At 11th Ave.
C	1985	8207-47 SF	Bituminous Surfacing Bituminous Shoulders	24-48' 8-3'	3 1/4" 3 1/2"	
M	1990	M4423	Bit. Overlay	24'	1 1/2"	Spec. 2341
C	1992	8207-51	Mill & Bit. Overlay	24-48'	2" 1"	Spec. 2331 Spec. 2361
C	1994	8207-52	Bit. Milling & Overlay	24'	1 1/2"	Spec. 2341

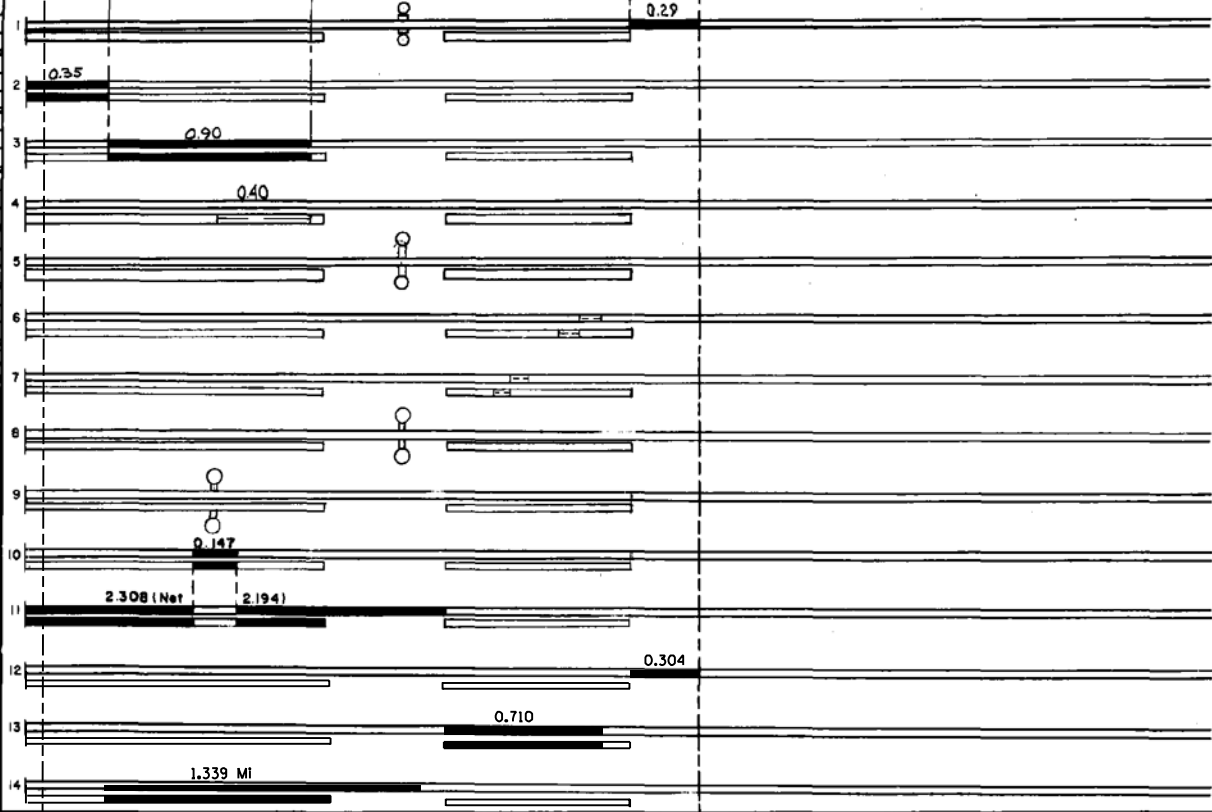

YEARS		TOTAL MILES	UNINCORPORATED		INCORPORATED		RURAL		URBAN	
FROM	TO		RDWY. MI.	BR. MI.	RDWY. MI.	BR. MI.	RDWY. MI.	BR. MI.	RDWY. MI.	BR. MI.

REMARKS: See Sheet 1

