

PREPARED BY  
HIGHWAY PLANNING SURVEY  
IN COOPERATION WITH  
U.S. PUBLIC ROADS ADMINISTRATION

STATE OF MINNESOTA  
DEPARTMENT OF HIGHWAYS  
ROAD LIFE STUDIES  
CONSTRUCTION PROJECT LOG RECORD

CONTROL SECTION 0506  
TRUNK HIGHWAY 25  
COUNTY Benton  
DISTRICT 3B

LIMITS: S. Co. Line - Jct. T.H. 95  
Ref. Pt. 091+00.804 - 093+00.873

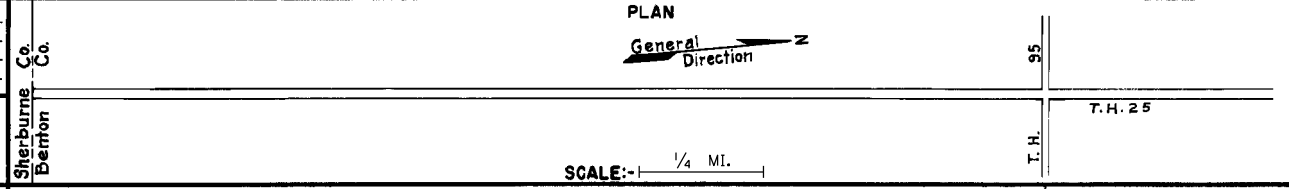

YEAR BUILT	PROJECT N°	DESCRIPTION				CODE N°
		TYPE	WIDTH	THICKNESS	REMARKS	
		Gravel	22'	2"	No Record of Constr	
		Br. N° 4544	19'		Added in 1934, 60 L.T.	
C		Grading	28'			
1955	A.F.E. 832	Stab. Gravel	28'			
		Portable Culs.				
C		Stab. Grav Base	26'	1 1/2"	MC-183 20571 Gal.	
1956	A.F.E. 819	Bit Surfacing			Agg. 14.8 Tons	
	A.F.E. 907*	Mix Bit. (Mix Prime)	24'	1"	* Seeding	
M		Repair Grav Base			MC-3, 1067 Gal.	
1957	A.F.E. 819	Restore Bit. Surf. (Spot)	24'		Agg. 91 Tons	
M		Bit. Seal Coat	25'		RS-2, 3623 Gal.	
1958	A.F.E. 605				Agg. 136 C.Y.	
M		Bit. Seal Coat	24'		RS-2, 3485 Gals.	
1962					Agg. 130 C.Y.	
C		Grading	118'		12" select granular matl. from mi. pt. 0.00 to 1.52	
1964	0506-05	Gr. wearing Course				
C		Gravel Base	43'	4 1/2"	9" gravel subbase from mi. pt. 1.52 to 2.06	
1965	0506-06	Plant mix Bit. Base	24'	1 1/2"		
C		Pl. Mix. Bit. Surf.	24'	2"		
		Gravel Shldrs.				
C		Bit. Overlay	24'	1 3/4"	Spec 2341	
1990	0506-08	Agg. Shouldering				
M		Aggregate Seal				
1999	M99180					
S		Bit., Milling & Surf	24'	2"		
2006	0506-10	Turn La Constr. & Culvert Repair		3"	Spec. 2360	
M		Bit. Seal Coat			FA-2	
2010	8823-159					
2015	0506-11	Bit. Mill & Overlay	24'	1.5"	Spec. 2360	

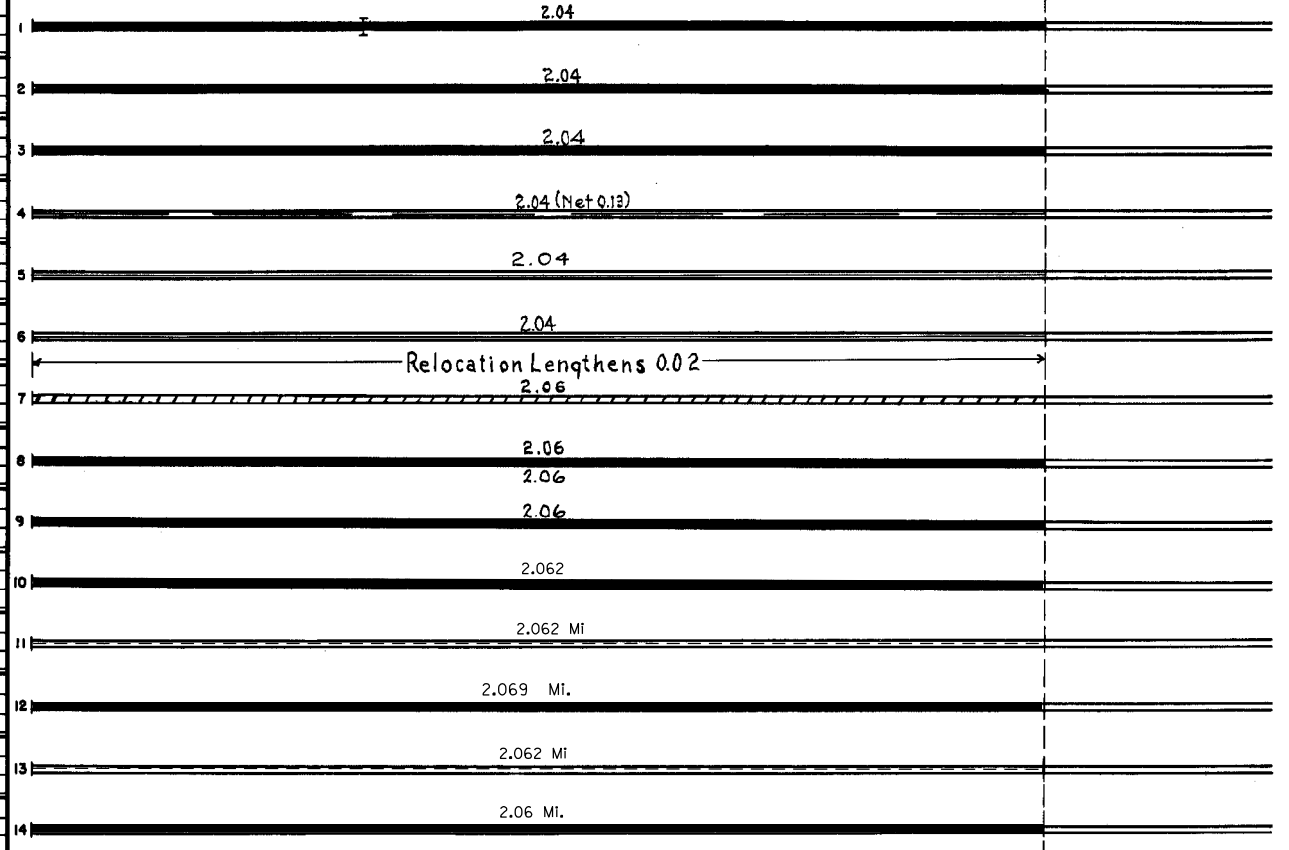

YEARS FROM	TO	TOTAL MILES	UNINCORPORATED		INCORPORATED		RURAL		URBAN		REMARKS: Layout is to scale as of 1934
			RDWY. MI.	BR. MI.	RDWY. MI.	BR. MI.	RDWY. MI.	BR. MI.	RDWY. MI.	BR. MI.	
1934	1963	2.04	2.03	0.01	0.00	0.00	2.03	0.01	0.00	0.00	
1964		2.06	2.06	0.00	0.00	0.00	2.06	0.00	0.00	0.00	